

274 Wolff Ave, Lunenburg NS B0J 2C0, CA

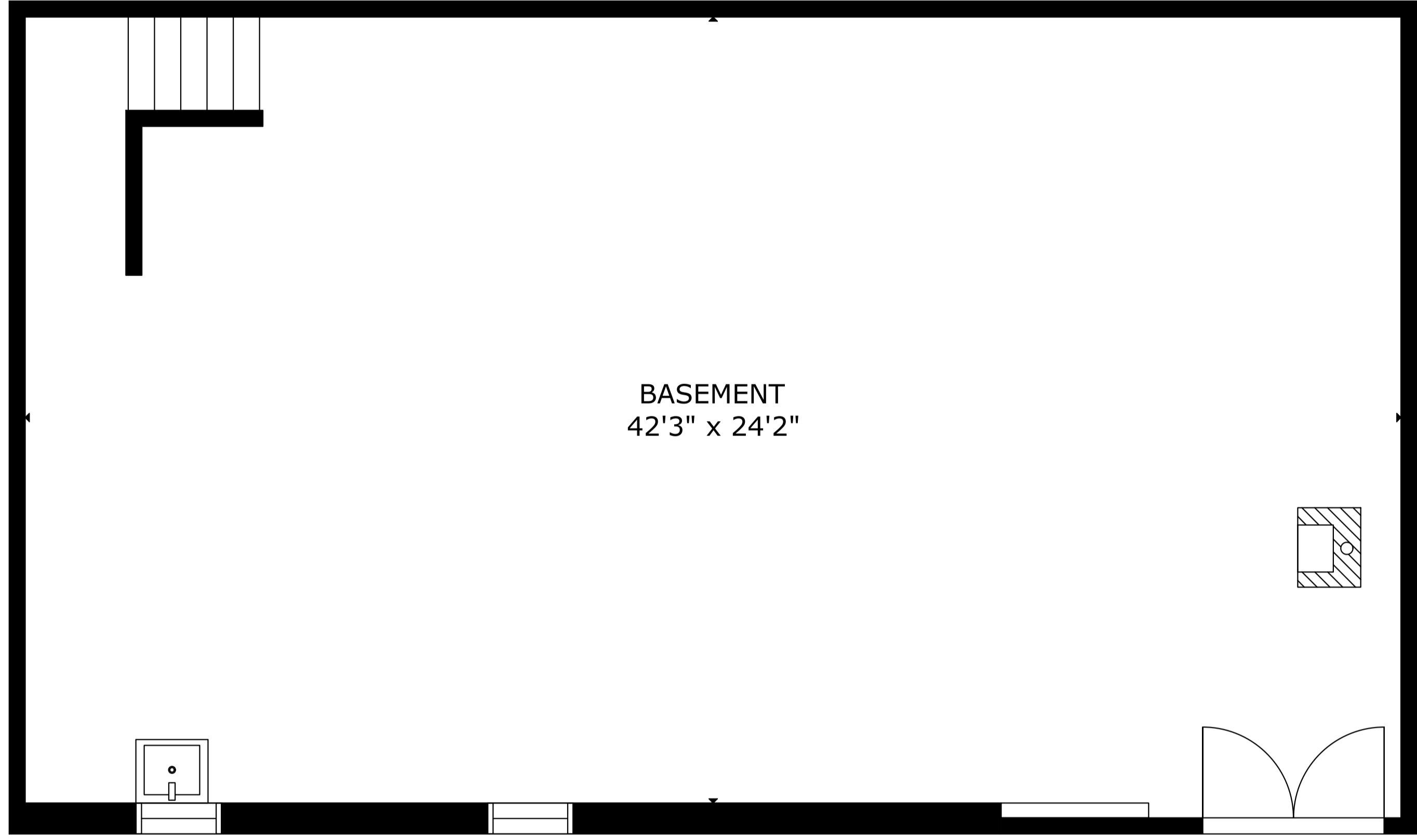

BASEMENT
42'3" x 24'2"

FLOOR 1

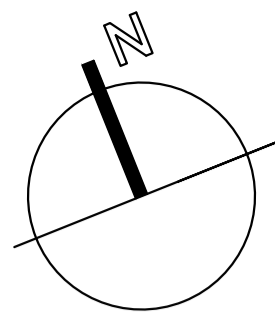
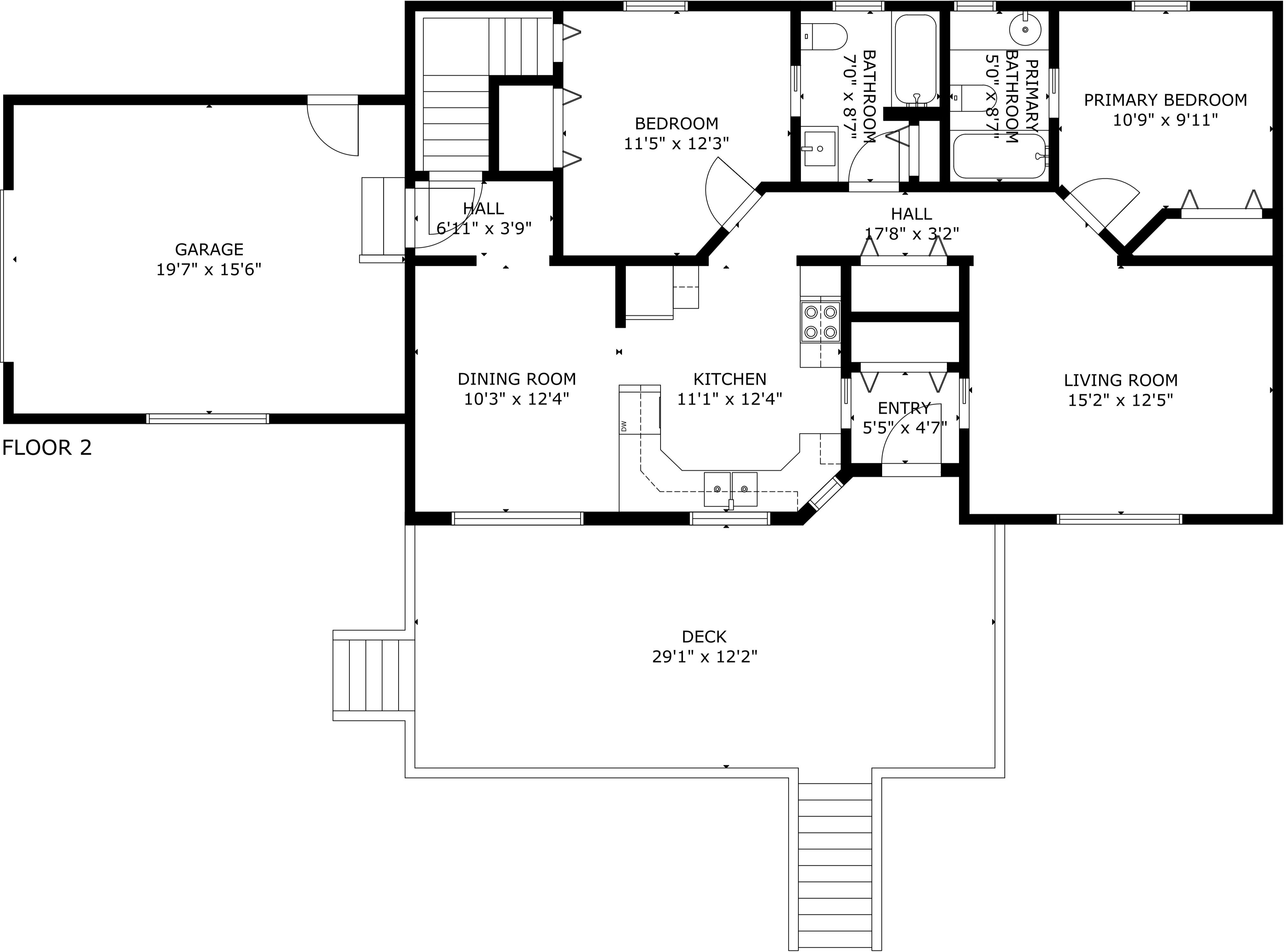

FLOOR 2

GROSS INTERNAL AREA
TOTAL: 2,103 sq.ft
FLOOR 1: 1,041 sq.ft, FLOOR 2: 1,062 sq.ft
EXCLUDED AREAS: GARAGE: 303 sq.ft, DECK: 353 sq.ft
SIZE AND DIMENSIONS ARE APPROXIMATE, ACTUAL MAY VARY

274 Wolff Ave, Lunenburg NS B0J 2C0, CA

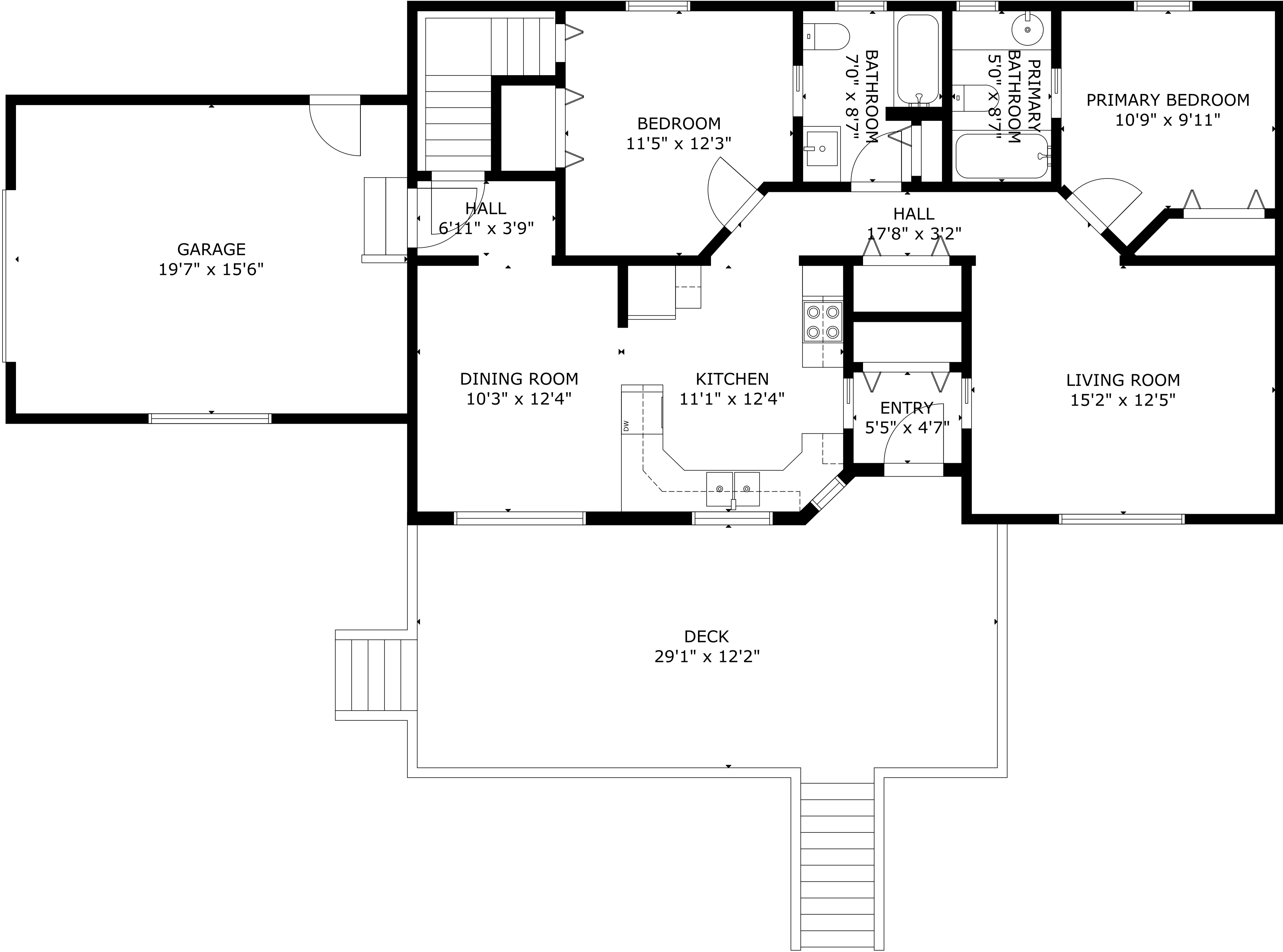
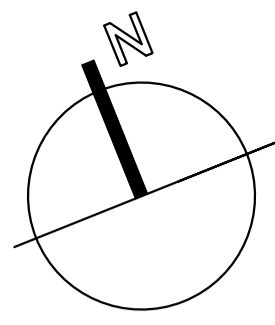

GROSS INTERNAL AREA
TOTAL: 2,103 sq.ft
FLOOR 1: 1,041 sq.ft, FLOOR 2: 1,062 sq.ft
EXCLUDED AREAS: GARAGE: 303 sq.ft, DECK: 353 sq.ft
SIZE AND DIMENSIONS ARE APPROXIMATE, ACTUAL MAY VARY

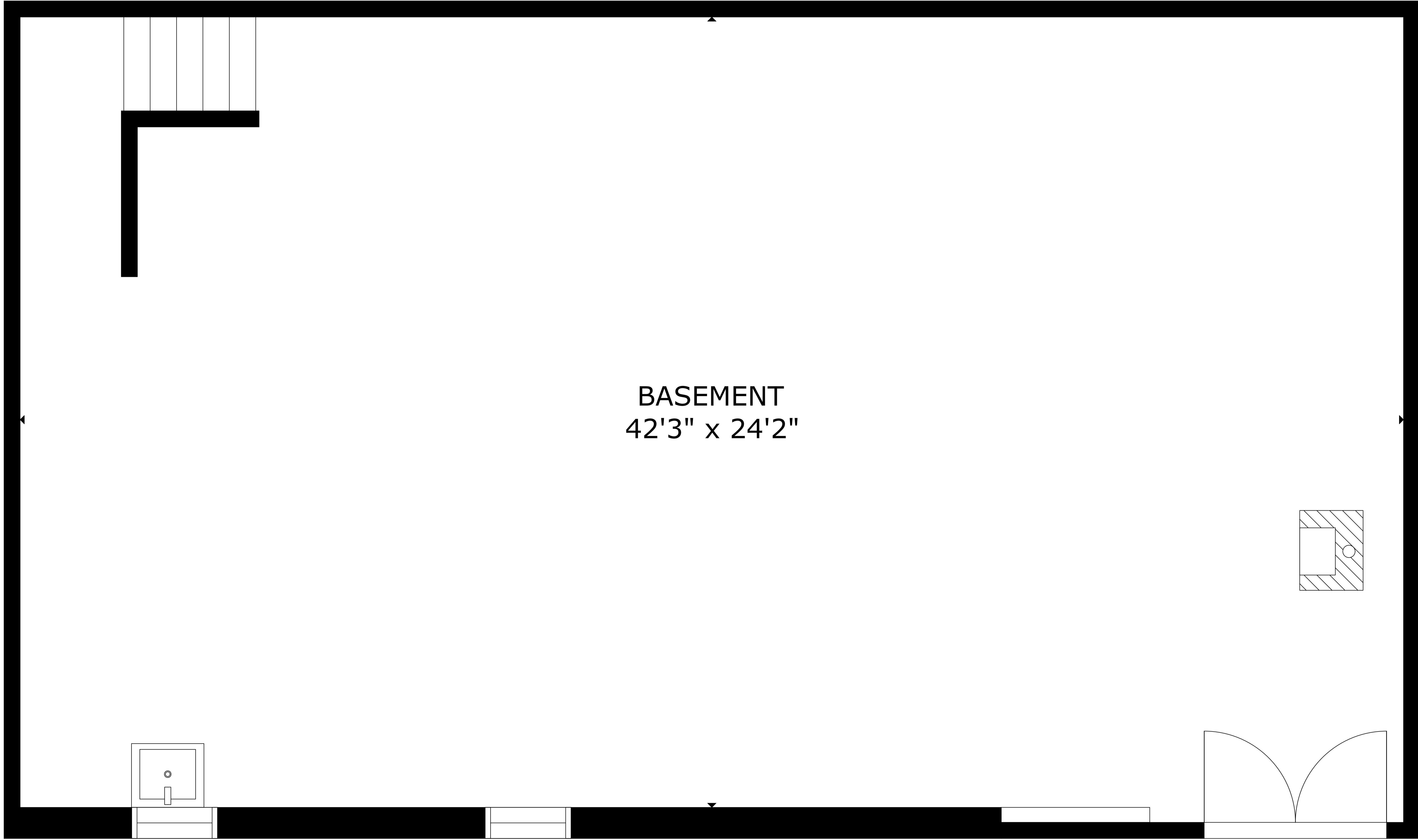
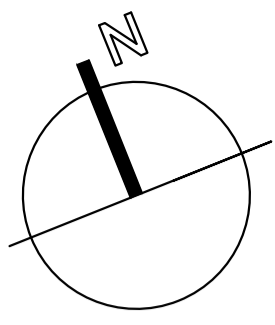

BASEMENT
42'3" x 24'2"

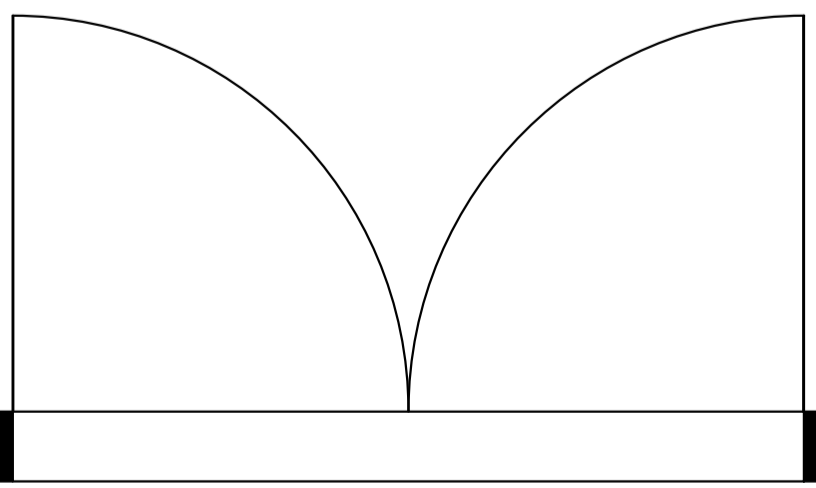
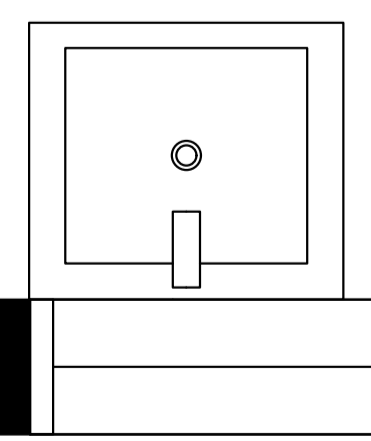
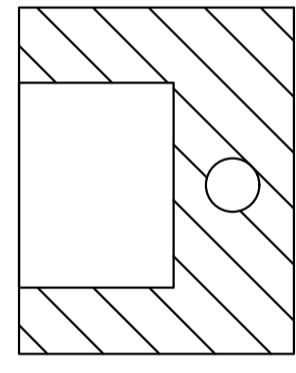

GROSS INTERNAL AREA
 TOTAL: 2,103 sq.ft
 FLOOR 1: 1,041 sq.ft, FLOOR 2: 1,062 sq.ft
 EXCLUDED AREAS: GARAGE: 303 sq.ft, DECK: 353 sq.ft
 SIZE AND DIMENSIONS ARE APPROXIMATE, ACTUAL MAY VARY